



# MONASH University

## Learning & Teaching Building

Paris-Roubaix Part 1  
Short Hard Indoor



Map drawn by Peter Dalwood with permission of Monash University. Possession of this map does not imply right of access to the building.  
© 2020 Dandenong Ranges Orienteering Club.



0428-358-588 www.vicorienteering.asn.au



- • × Tree | Pillar | Other prominent object
- Step or paving edge
- - - Door - open | closed, but passable | impassable
- - - Wall - passable | impassable
- ▨ Paved area (outside) | Grassed or open area (outside)
- ▩ Canopy (passable)
- ▧ Impassable room or structure
- Furniture (may reach across, but not move)
- ▬ Garden or other area forbidden to enter or reach across
- ▨ Passable area (inside) - at floor level | between floors
- ▨ Passable area (inside) with unmapped furniture
- ▨ Stairs: within one floor level
- ▨ A between floors (same letter on each floor)
- ▨ × Uncrossable barrier | Blocked route
- ▨ Out of bounds for competitors
- ▨ Void - no floor

Scale: 1:1000



Monash Indoor-Outdoor Pop-up	
Short Hard	
Paris-Roubaix	3.8 km
----- 15 m ----->△	
▷	
1 41	×
2 83	⊛
3 73	▨
4 79	■
5 78	▨

6 74	▨		⊙
7 82	×		—
8 81	▨	]]	—
9 77	▨		⊙
10 80	▨	]]	—
11 76	▨		∨
12 75	▨		⊙
13 42	▨		—
14 43	▨		⊙
Turn map over			

www.condes.net 9,7,21 Dandenong Ranges Orienteering Club

North

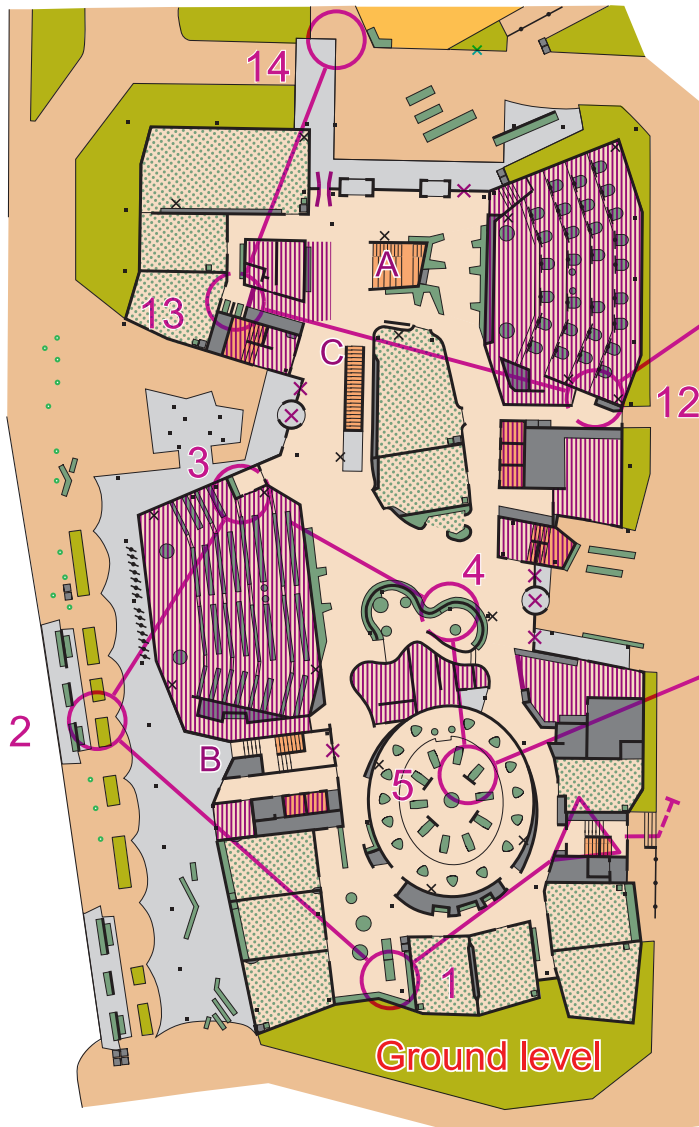

North

